

PLAN SHOWING THE PRO. RESIDENCE AT PLOT NO. 21, IN S.NO. 11/1A1D OF PALAVAKKAM VILLAGE, TAMBARAM TALUK, KANCHI PURAM DISTRICT, ST. THOMAS MOUNT PANCHAYAT UNION.



SCALE = 1" : 8' [1 : 100]

SPECIFICATION

1. R.C.C. COLUMN & FOOTING
2. SAND FILLING IN BASEMENT & FOOTING
3. P.C.C. 1:4:8 IN FOUNDATION & FLOORING CONCRETE
4. MOSIC FLOORING IN C.M. 1:3 MIX
5. BRICK WORK IN C.M. 1:5 IN BASEMENT SUPER STRUCTURE, PARAPET WALL ETC.
6. R.C.C. COLUMN, BEAM, ROOF SLAB, LINTELS, EXT. IN 1:2:4 MIX
7. PLASTERING IN C.M. 1:4

AREA DETAILS

SITE EXTENT : 3800.00 SQ.FT. : 353.15 SQ.M.
 G.F AREA : 2270.00 SQ.FT. : 210.96 SQ.M.
 F.F AREA : 2010.00 SQ.FT. : 186.80 SQ.M.
 F.S.I : 1.12 PLOT COVERAGE : 59%

SCHEDULE OF JOINERY

MD - DOOR	: 3'-3" x 7'-0"
D1 - DOOR	: 3'-0" x 7'-0"
D2 - DOOR	: 2'-6" x 6'-6"
W1 - WINDOW	: 4'-5" x 4'-6"
W2 - WINDOW	: 4'-0" x 4'-6"
WK - KITCHEN WINDOW	: 4'-6" x 3'-0"
V - VENTILATOR	: 2'-0" x 2'-0"

COLOUR INDEX

- PROPOSED CONSTRUCTION
- EXISTING ROAD
- SITE BOUNDARY

OWNER SIGNATURE

A. GANESAN
 LICENCED SURVEYOR
 PALLAVAPURAM MUNICIPALITY
 OFF : NACHAR CONSTRUCTION,
 No. 75, Station Road, First Floor
 RADHA NAGAR
 CHROMEPET, CHENNAI-600 044
 LICENCED SURVEYOR

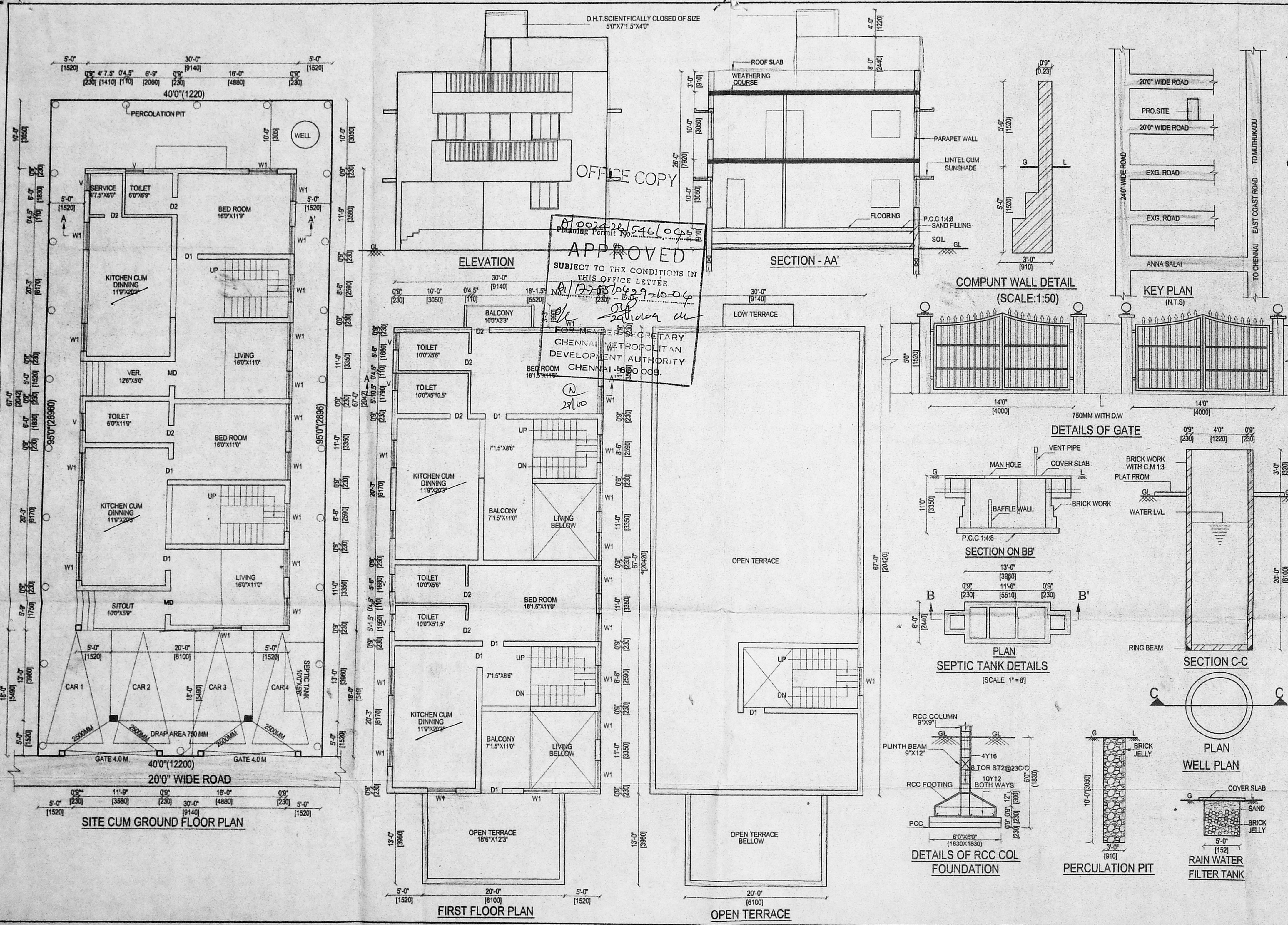

OFFICE COPY
 Planning Permit No. 01/27/2015/10-0-0-0
APPROVED
 SUBJECT TO THE CONDITIONS IN THIS OFFICE LETTER
 FOR MEMBER SECRETARY
 CHENNAI METROPOLITAN
 DEVELOPMENT AUTHORITY
 CHENNAI-600 005.

E. scholar